



## TECHNICAL DATA SHEET

Mod. AH 1040<sup>E</sup>

### GENERAL FEATURES

- Rack dimensions: **50x50 cm**
- Total weight: 140 Kg
- Wash cycles/racks per hour: 60"-120"-180"-9"/60-30-20-7
- "START&STOP" of washing cycle by closing the hood
- Stainless-steel wash/rinse arms
- Wash pump: 1 kW
- Boiler capacity: 8 liters
- Tank capacity: 30 liters
- Boiler heating element: 9 kW (6 kW at 230V)
- Tank heating element: 2,8 kW
- Water quantity per cycle: 2,5 liters
- Electronic controls with LCD display
- Useful washing height: 415 mm
- Magnetic hood microswitch
- Automatic water filling
- Double electric detergent and rinse-aid dispenser
- Hot rinse
- Thermostop function
- Vertical self-cleaning washing pump
- Green function for energy saving
- Self-cleaning cycle at the end of the day

### WATER FILTRATION

- Pre-filtering of the tank water by means of stainless-steel filter
- Plastic pump filter, easily removable

### BODY

- AISI 304 stainless-steel body
- Single skinned hood
- Preformed wash tank with rounded corners
- Hood opening system with springs
- Upper and lower wash/rinse arms easily removable
- Boiler in stainless-steel AISI 304

### EQUIPMENT

- 2 plate racks 50x50 cm
- 1 glass rack 50x50 cm
- 2 cutlery baskets
- 1 inlet hose (length 2 mt)
- 1 drain hose (length 2 mt)

### OPTIONS

- Drain pump
- Hot water filling (max 85°C)
- HD version (Tot. P. 12,8 kW, in 380-415V 3N~)
- 60Hz version
- Kit booster pump
- Kit remote control system

### ACCESSORIES FOR WATER TREATMENT

- Built-in water softener ("S" version)
- External water softener

### ACCESSORIES

- Entry / exit tables in stainless-steel
- Pre-wash tables in stainless-steel
- Special racks

### INSTALLATION

- Use the screws of the feet and a spirit level to ensure that the machine is levelled

### MAIN POWER SUPPLY

- The voltage of main power supply must be compatible with the rated voltage
- The machine must be connected to a suitable earth (ground) system
- Connect the machine power socket to the multi-pole wall switch provided

### WATER SUPPLY CONNECTION

- A water softener must be installed if the water is hard
- The water pressure must be between 0.2MPa (2 bar) and 0.5MPa (5 bar)
- The temperature of the water supply must be between 10°C to 50°C (max 25°C with water softener)

### TECHNICAL SPECIFICATIONS

- Electrical supply: **380-415V 3N / 220-240V3**  
**220-240V ~ 50Hz**
- Total power: **10 kW (12,8 kW in HD)**
- Absorbed current: **15 A / 25 A / 31 A (25 A in HD)**
- Power cord supply size: **5 x 2,5 mm<sup>2</sup> / 3 x 4 mm<sup>2</sup>**

## AH 1040<sup>E</sup>

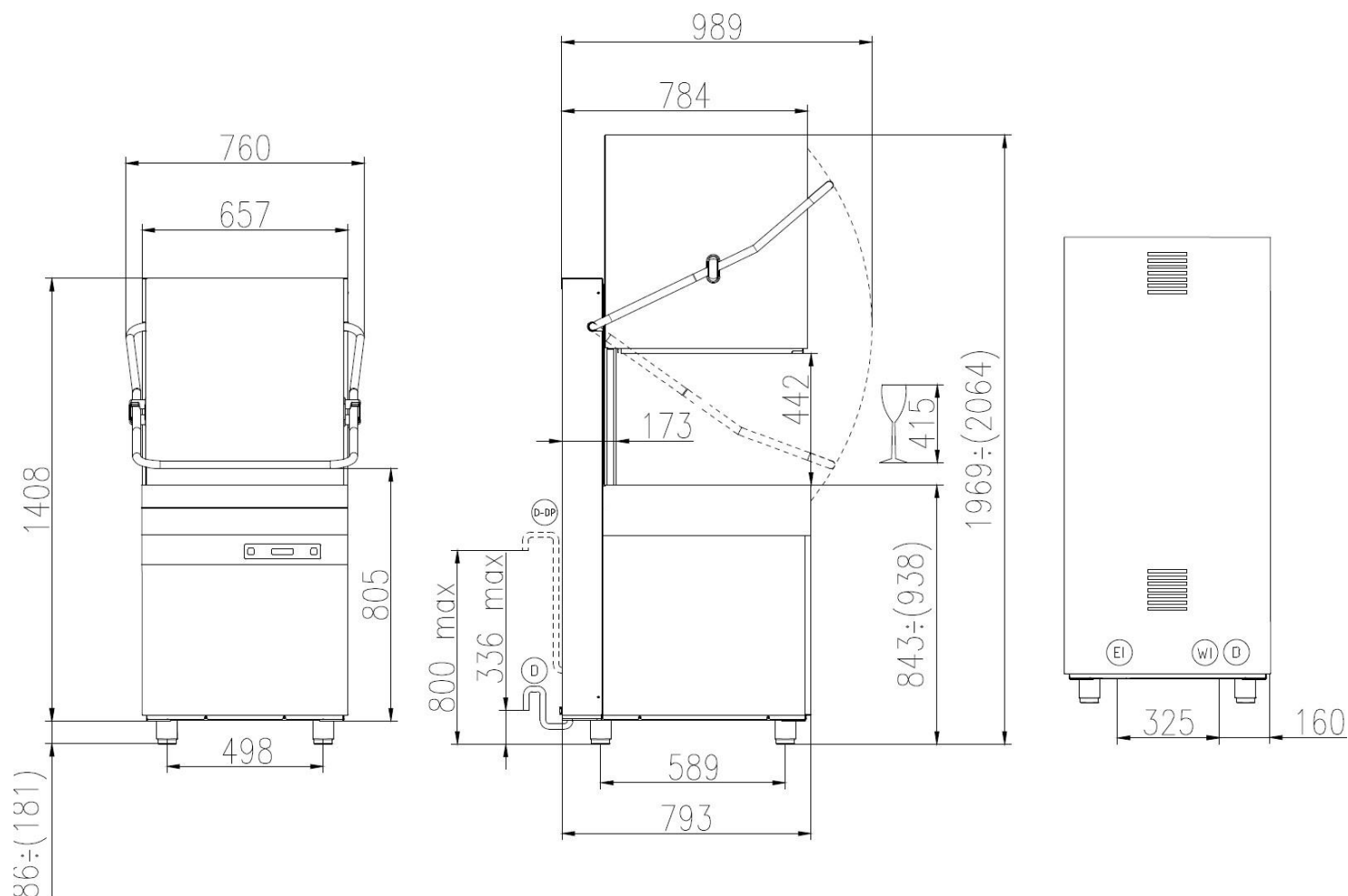

- EI** CAVO DI ALIMENTAZIONE  
POWER CORD SUPPLY  
CABLE D'ALIMENTATION  
CABLE DE ALIMENTACION
- WI** CANNA DI CARICO G 3/4" L=2000 mm  
G 3/4" INLET HOSE L=2000 mm  
TUYAU D'ALIMENTATION G 3/4" L=2000 mm  
TUBO DE ALIMENTACION G 3/4" L=2000 mm
- D** TUBO DI SCARICO Ø 40 mm L=2000 mm  
DRAIN HOSE Ø 40 mm L=2000 mm  
TUYAU DE VIDANGE Ø 40 mm L=2000 mm  
TUBO DE DESAGUE Ø 40 mm L=2000 mm
- D-DP** TUBO DI SCARICO Ø 29 mm L=2500 mm (CON POMPA SCARICO)  
DRAIN HOSE Ø 29 mm L=2500 mm (WITH DRAIN PUMP)  
TUYAU DE VIDANGE Ø 29 mm L=2500 mm (AVEC POMPE DE VIDANGE)  
TUBO DE DESAGUE Ø 29 mm L=2500 mm (CON POMPA DE DESAGUE)

	Min 10°C-MAX 50°C
	Min 10°C-MAX 25°C with ENERGY RECOVERY
	200÷500kPa(2÷5 Bar)
	100÷500kPa(1÷5 Bar) with ATMOSPHERIC BOILER
	HARDNESS 5÷20f-2.8÷11'd